



## IN-Line Consulting, LLC

402 Bell Court  
Woodstock, GA 30188

Insured: Public Risk Management - Sun 'N Lakes Recreation  
Loc. 11A-F & PITO 11A  
Property: 5306 Sun N Lake Boulevard  
Sebring, FL 33872

Estimator: David Beard  
Position: Executive Consultant  
Company: IN-Line Consulting, LLC  
Business: 7021 Grand National Drive, Suite 107  
Orlando, FL 32819

Business: (321) 689-8022  
E-mail: dbeard@inline.us

**Claim Number:** MULTIPLE

**Policy Number:** MULTIPLE

**Type of Loss:** Hail

<b>Coverage</b>	<b>Deductible</b>	<b>Policy Limit</b>
Commercial	\$0.00	\$0.00
Loc 11D	\$0.00	\$0.00

Date Contacted: 5/13/2022 3:43 PM  
Date of Loss: 4/4/2022 3:43 PM  
Date Inspected: 5/13/2022 3:43 PM

Date Received: 5/13/2022 3:43 PM  
Date Entered: 5/13/2022 3:43 PM

Price List: FLSE8X\_APR22  
Restoration/Service/Remodel  
Estimate: SNL0011-D

Branch-File#: 3975474



File No.: 22-5800

Claim No.: MULTIPLE

Client File No.: 3975474

**This estimate is preliminary and subject to review and revision.**

**This estimate does not address any code upgrades which may be required.**

Created by IN-Line Consulting, LLC. All rights reserved. Printed in the United States of America. No part of this document may be reproduced, stored in a retrieval system, or transmitted in any form by any means, electronic, mechanical, photocopying, recording, or otherwise, without the prior written permission of IN-Line Consulting, LLC.

IN-Line Consulting, LLC shall not be responsible for any loss, liability, damage, expense or cost arising from any use of the IN-Line Consulting, LLC analysis, reports, certifications or advice, which is used by anyone other than the Client or is used contrary to, or inconsistent with, or beyond the provisions and purposes set forth herein. Client understands and agrees that the IN-Line Consulting, LLC analysis, reports, and certifications shall be used solely by the Client.

The documents are furnished for Client's exclusive internal use and reliance, only. All documents generated by IN-Line Consulting, LLC shall remain the sole property of IN-Line Consulting, LLC. Any unauthorized use or distribution of the IN-Line Consulting, LLC work shall be at Client's and recipient's sole risk and without liability to IN-Line Consulting, LLC.

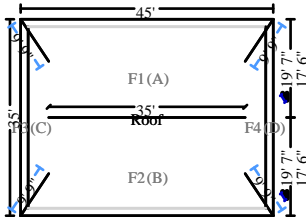
**SNL0011-D**
**Recreation Center Loc. 11**
**Playground Pavillion 11D EV#45759108**

**Roof**

1797.19	Surface Area	17.97	Number of Squares
160.00	Total Perimeter Length	35.00	Total Ridge Length
39.05	Total Hip Length		

**DESCRIPTION**
**QTY**

1. R&R Bitumen roof - Add. glass felt layer - hot mopped appl.	18.24 SQ
2. R&R Drip edge	215.00 LF
3. R&R Flashing, 14" wide	39.00 LF
4. R&R Metal roofing	1824.00 SF
5. Re-nailing of roof sheathing - complete re-nail	1824.00 SF
6. R&R Ridge cap - metal roofing	66.00 LF
7. Step flashing	13.00 LF
8. R&R Fascia - metal - 6"	215.00 LF

**NOTES:**
**Front Elevation**
**DESCRIPTION**
**QTY**

9. Commercial sign face	3.00 SF
10. Prime & paint exterior fascia - metal, 4"- 6" wide	35.00 LF

**NOTES:**



**Right Elevation**

DESCRIPTION	QTY
11. Prime & paint exterior fascia - metal, 4" - 6" wide	45.00 LF

NOTES:

**Left Elevation**

DESCRIPTION	QTY
12. Prime & paint exterior fascia - metal, 4" - 6" wide	45.00 LF

NOTES:

**Rear Elevation**

DESCRIPTION	QTY
13. Prime & paint exterior fascia - metal, 4" - 6" wide	35.00 LF

NOTES:

**Equipment**

DESCRIPTION	QTY
-------------	-----



**CONTINUED - Equipment**

DESCRIPTION	QTY
14. Rental equipment delivery / mobilization (Bid item)	0.10 EA
15. Telehandler/forklift and operator	8.00 HR

NOTES:

**General Conditions**

DESCRIPTION	QTY
16. Taxes, insurance, permits & fees (Bid Item)	1.00 EA
<a href="https://sebring-airport.com/wp-content/uploads/2015/08/Building_Fee_Schedule_Revised_For_10_1_14.pdf">https://sebring-airport.com/wp-content/uploads/2015/08/Building_Fee_Schedule_Revised_For_10_1_14.pdf</a>	
17. General Laborer - per hour	40.00 HR
Keep work area safe and clean. Load materials to island.	
18. Commercial Supervision / Project Management - per hour	8.00 HR
Supervision of sub contractors and be resent for building inspections.	
19. Temporary toilet (per month)	0.20 MO

NOTES:

**Grand Total Areas:**

0.00	SF Walls	0.00	SF Ceiling	0.00	SF Walls and Ceiling
0.00	SF Floor	0.00	SY Flooring	0.00	LF Floor Perimeter
0.00	SF Long Wall	0.00	SF Short Wall	0.00	LF Ceil. Perimeter
0.00	Floor Area	0.00	Total Area	0.00	Interior Wall Area
21.11	Exterior Wall Area	0.00	Exterior Perimeter of Walls		
1,797.19	Surface Area	17.97	Number of Squares	160.00	Total Perimeter Length
35.00	Total Ridge Length	39.05	Total Hip Length		

